

Drawing Number 70080518-WSP-DRG-ETR-000201

HINCKLEY NATIONAL RAIL FREIGHT INTERCHANGE

Date: 14/10/2022
Paper Size: A0
Scale: 1:2000

Key:

Proposed Tracks	
Existing Tracks	
Runaround Track with Chainage	
Potential Retaining Wall	
Acoustic Fence	
Driver Platform	
Order Limits	
Limits of Deviation to Rail Infrastructure	
Maintenance Path	
Existing Network Rail Fence-line	
Proposed Network Rail Fence-line	
Proposed Railport Gate	
Buffer Stop	
Container	
Section Line (A-A)	

For Sections A-A, B-B & C-C please refer to drawing: 70080518-WSP-DRG-ETR-000209-P01 (2.23.1)
For Runaround Long Section please refer to drawing: 70080518-WSP-DRG-ETR-000206-P01 (2.23.2)

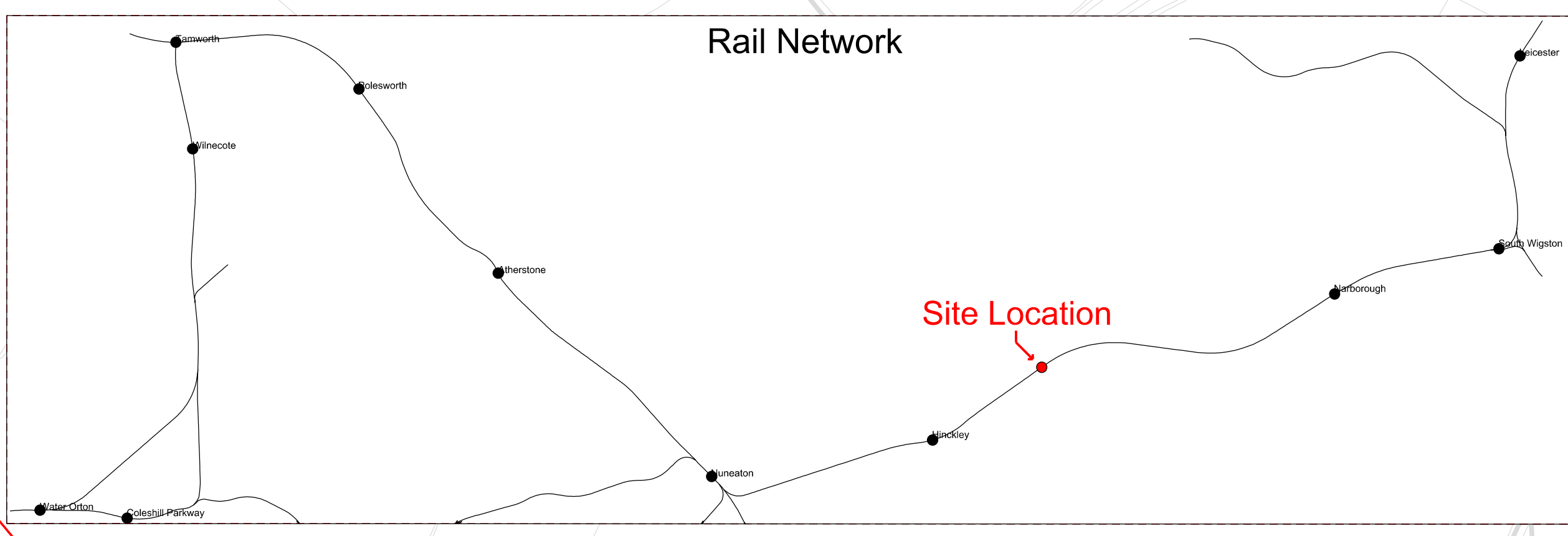

Illustrative Railport General Arrangement Sheet 2 of 3 (2.25.3)

Illustrative Railport General Arrangement Sheet 1 of 3 (2.25.2)

Illustrative Railport General Arrangement Sheet 3 of 3 (2.25.4)

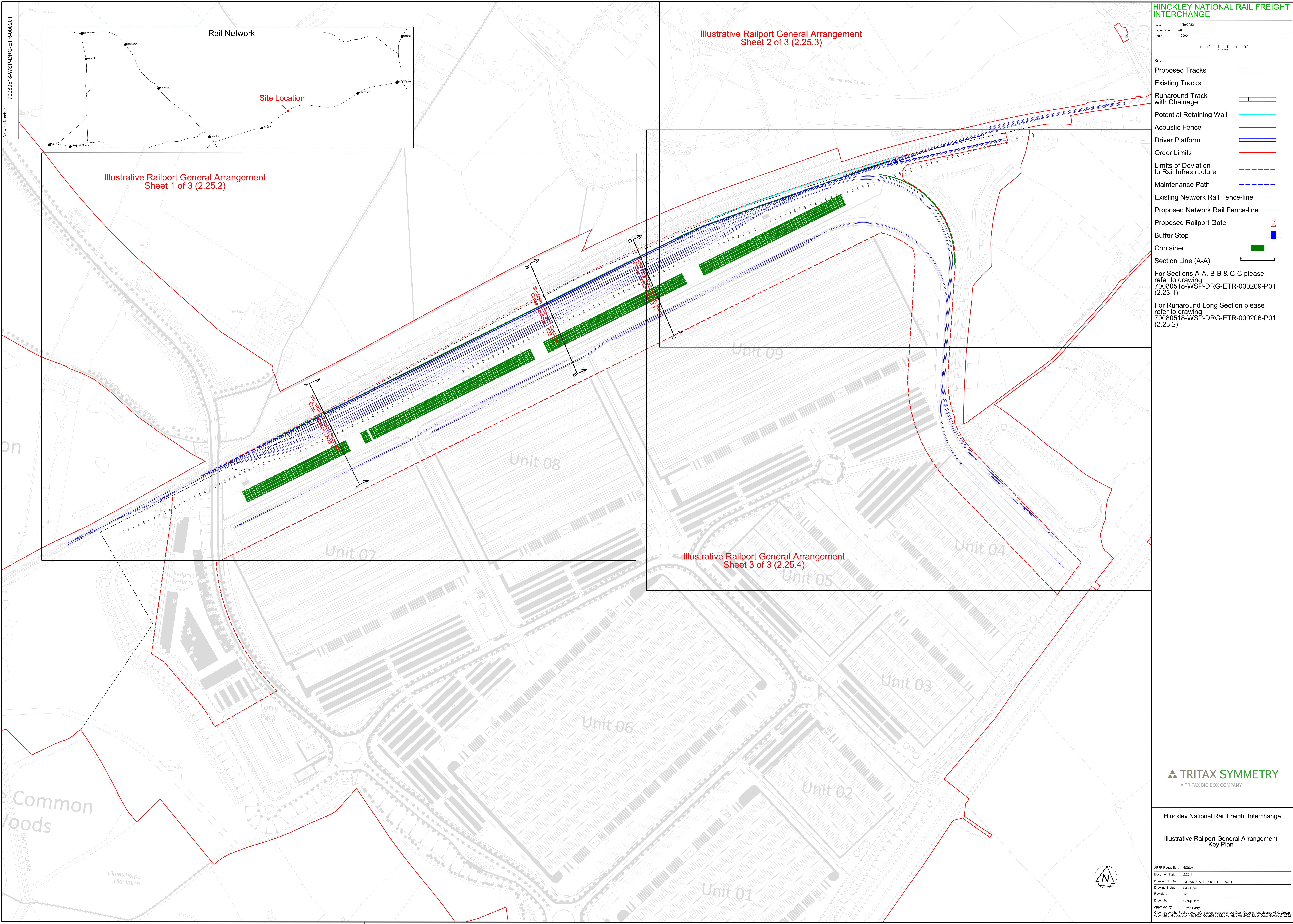

Hinckley National Rail Freight Interchange
Illustrative Railport General Arrangement Key Plan

APFF Regulation:	52(6)
Document Ref:	2.25.1
Drawing Number:	70080518-WSP-DRG-ETR-000201
Drawing Status:	S4 - Final
Revision:	pg1
Drawn by:	Georg Reef
Approved by:	David Parry

© Crown copyright. Public sector information licensed under Open Government Licence v3.0. Other copyright and database right 2022. OpenStreetMap contributors 2022. Map data: Google © 2022